

- LEGEND**
- Site Boundary
 - Housing, soft landscaping, and hard standing adopted and maintained by Housing Association with wayleave access as a service strip, sewer wayleave or fibre cable wayleave. Plots 5-16 & 53-64 (Red diagonal hatch and red boundary).
 - Private hardstanding area shared between plots 1-2, maintained by factor, with wayleave access as a service strip, sewer wayleave or fibre cable wayleave. (Blue)
 - Private hardstanding area shared between plots 26-29, maintained by factor, with wayleave access as a service strip, sewer wayleave or fibre cable wayleave. (Orange with hatch)
 - Private hardstanding area shared between plots 34-36, maintained by factor, with wayleave access as a service strip, sewer wayleave or fibre cable wayleave. (Yellow)
 - Private hardstanding area shared between plots 37-41, maintained by factor, with wayleave access as a service strip, sewer wayleave or fibre cable wayleave. (Light Pink)
 - Private hardstanding area shared between plots 79-82, maintained by factor, with wayleave access as a service strip, sewer wayleave or fibre cable wayleave. (Purple)
 - Private hardstanding area shared between plots 83-86, maintained by factor, with wayleave access as a service strip, sewer wayleave or fibre cable wayleave. (Dark Pink)
 - Private hardstanding area shared between plots 94-96, maintained by factor, with wayleave access as a service strip, sewer wayleave or fibre cable wayleave. (Dark Green)

Revision	Amendment	Date	Initials
D	DPA updated following landscape review.	12.09.24	DM
C	DPA updated following roads, Planning and BC comments.	04.07.24	DM
B	Red line boundary amended to match legal boundary	13.06.23	DM
A	Amended to show 3.0 accessible parking bays	03.05.23	DM

The Development registered under title MID135280 and plots 1 to 4, 17 to 52 and 65 to 94 within have been DPA approved.

The Keeper - 16 September 2024

Keeper for the Registers of Scotland

Persimmon
Persimmon Homes (East Scotland)

Development
Gorebridge,
Newbyres

Drawing Title DPA PLAN	Date 23/01/23	Scale 1/500@A1	Drawn / Checked by DM/AF
Drawing Status LEGAL	Drawing Ref NBG/08/01		Rev D

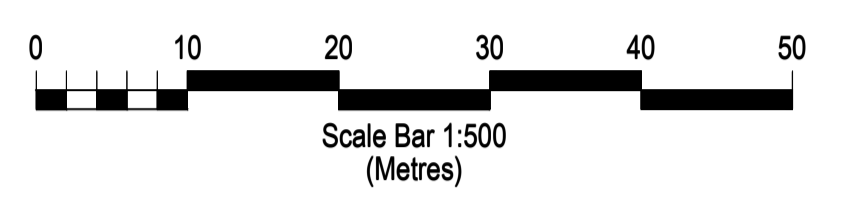
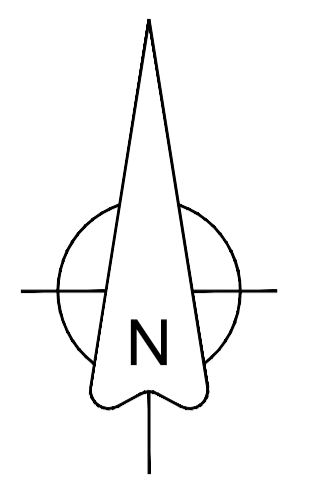
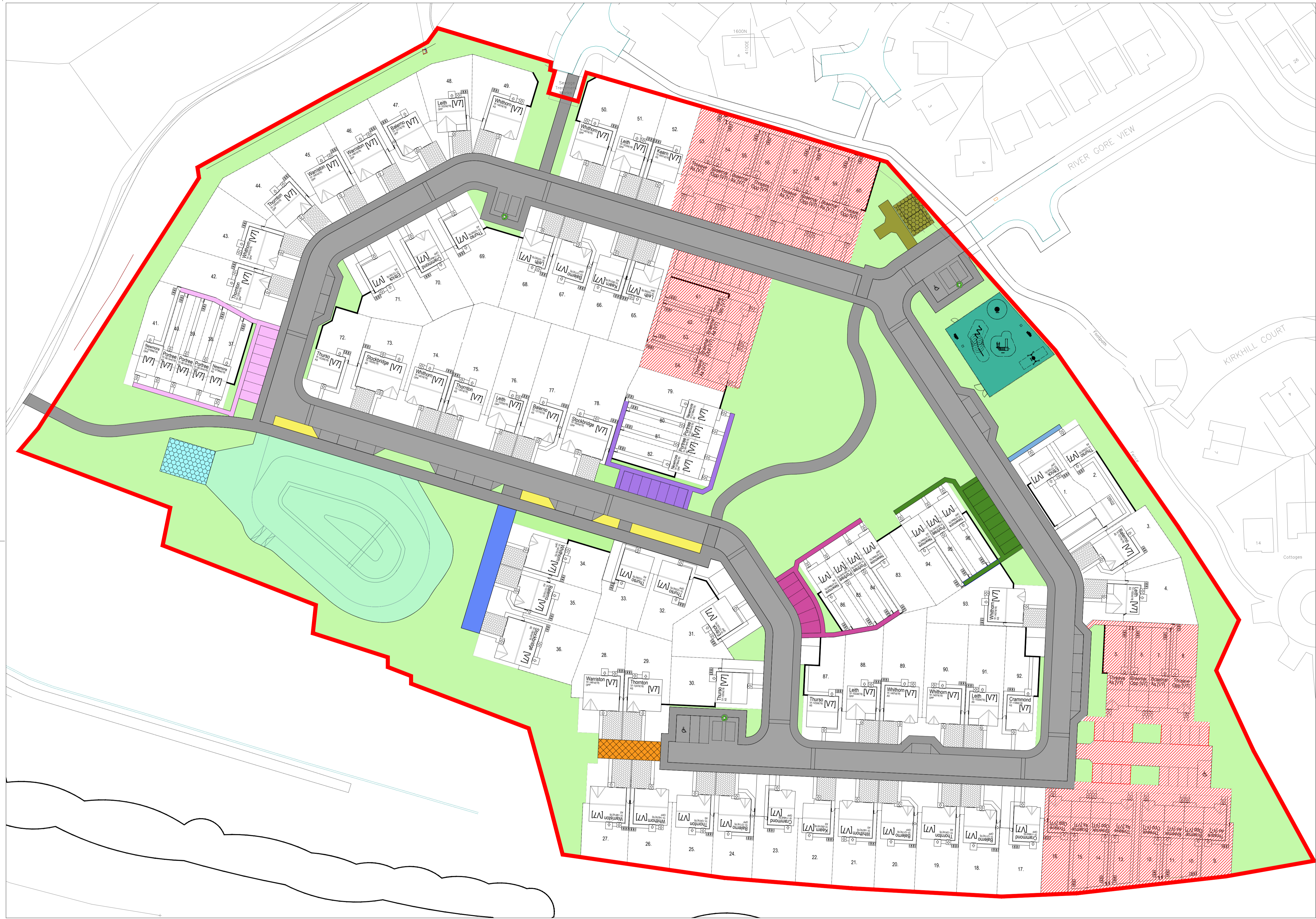

- LEGEND**
- Site Boundary
 - Housing, soft landscaping, and hard standing adopted and maintained by Housing Association. Plots 5-16 & 53-64 (Red diagonal hatch and red boundary)
 - Roadways, footpaths, street signs and parking adopted and maintained by Midlothian Council Roads Department with wayleave access as a service strip, sewer wayleave or fibre cable wayleave. (Grey)
 - Public open space, pathways, street furniture, public artwork and landscaping maintained by factor with wayleave access as a service strip, sewer wayleave or fibre cable wayleave. (Light Green)
 - Private hardstanding area shared between plots 1-2, maintained by factor, with wayleave access as a service strip, sewer wayleave or fibre cable wayleave. (Blue)
 - Private hardstanding area shared between plots 26-29, maintained by factor, with wayleave access as a service strip, sewer wayleave or fibre cable wayleave. (Orange with crosshatch)
 - Private hardstanding area shared between plots 34-36, maintained by factor, with wayleave access as a service strip, sewer wayleave or fibre cable wayleave. (Yellow)
 - Private hardstanding area shared between plots 37-41, maintained by factor, with wayleave access as a service strip, sewer wayleave or fibre cable wayleave. (Light Pink)
 - Private hardstanding area shared between plots 79-82, maintained by factor, with wayleave access as a service strip, sewer wayleave or fibre cable wayleave. (Purple)
 - Private hardstanding area shared between plots 83-86, maintained by factor, with wayleave access as a service strip, sewer wayleave or fibre cable wayleave. (Dark Pink)
 - Private hardstanding area shared between plots 94-96, maintained by factor, with wayleave access as a service strip, sewer wayleave or fibre cable wayleave. (Dark Green)
 - Pumping station to be adopted by Scottish Water. (Teal with hatch)
 - SUDS basin to be adopted by Scottish Water. SUDS basin landscaping to be maintained by factor (Teal)
 - Substation & switching station to be adopted and maintained by the utility provider (Olive Green with hatch)
 - Substation access road to be maintained by factor. Wayleave access as a service strip, sewer wayleave or fibre cable wayleave (Olive Green)
 - Equipped play area and associated furniture and fencing to be maintained by factor (Aqua)
 - Service strip, adopted by Midlothian Council Roads Department and maintained by Factor (Yellow)
 - EV Charging to be maintained by Factor

Revision	Amendment	Date	Initials
D	DMS updated following landscaping review.	12.09.24	DM
C	DMS updated following roads, Planning and BC comments.	04.07.24	DM
B	Red line boundary amended to match legal boundary	13.06.23	DM
A	Amended to show 3, no accessible parking bays	03.05.23	DM

Persimmon
Persimmon Homes (East Scotland)

Development
**Gorebridge,
Newbyres**

Drawing Title	Date	Scale	Drawn / Checked by
DMS PLAN	23/01/23	1/500@A1	DM/AF
Drawing Status	Drawing Ref	Rev	
LEGAL	NBG/08/02	D	