

1 Block Plan
Scale: 1:500

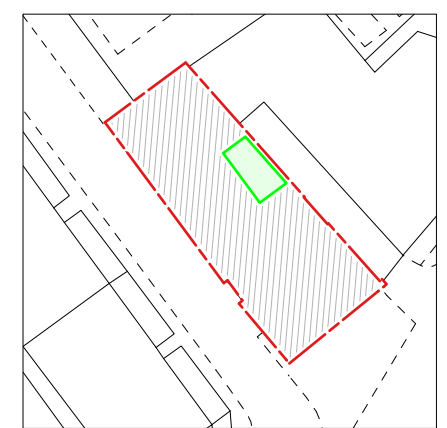

THIRD FLOOR



BASEMENT FLOOR

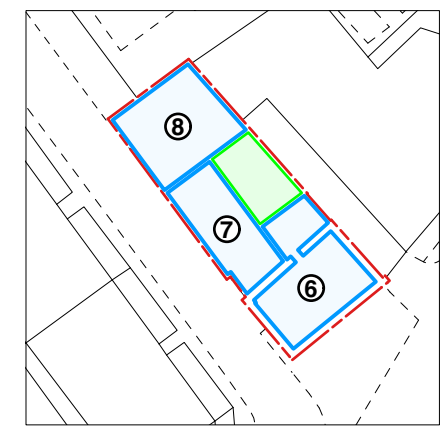

SECOND FLOOR

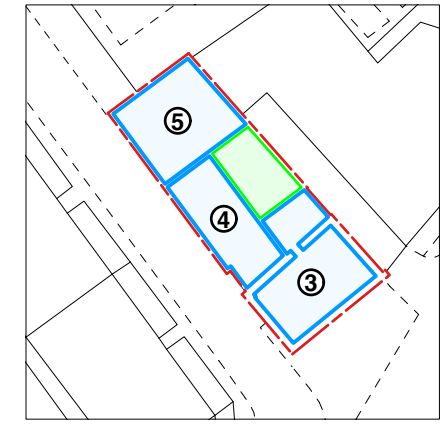

FIRST FLOOR

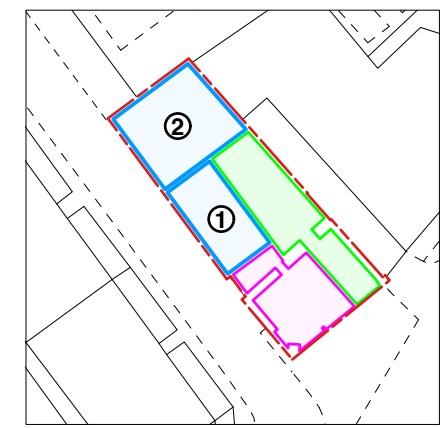

GROUND FLOOR

The Development registered under title MID176847 and plots 1 to 9 within have been DPA approved.

The Keeper - 28 January 2025

Keeper for the Registers of Scotland



Key

- Site Boundary
- Plot Boundary
- Common Factored Area
- Commercial Unit
- x Plot Number

ISSUE	DATE	REVISION

NOTE
DO NOT SCALE FROM DRAWING. USE FIGURED DIMENSIONS ONLY. ALL DIMENSIONS MUST BE CHECKED ON SITE AND ANY DISCREPANCIES, ERRORS OR OMISSIONS REPORTED.

PROJECT
1-3 Canon Street, Edinburgh

CLIENT
Thistle Property Group

DRAWING
Deed of Conditions Plan

P E N D
www.pendarchitects.com



DATE	JOB CODE	DWG #	REV
20/01/2025	CANS	710	

ISSUE
AS BUILT

CANS 710

