

OWNERSHIP SCHEDULE

- SHARED PRIVATE DRIVE (1) - between Plots 130 and 131
- SHARED PRIVATE DRIVE (2) - between Plots 132 and 133
- SHARED PRIVATE DRIVE (3) - between Plots 134 and 135
- SHARED PRIVATE DRIVE (4) - between Plots 136 and 137
- SHARED PRIVATE DRIVE (5) - between Plots 138 and 139
- SHARED PRIVATE DRIVE (6) - between Plots 140 and 141
- SHARED PRIVATE DRIVE (7) - between Plots 142 and 143
- SHARED PRIVATE DRIVE (8) - between Plots 144 and 145
- SHARED PRIVATE DRIVE (9) - between Plots 146 and 147
- SHARED PRIVATE DRIVE (10) - between Plots 148 and 149
- SHARED PRIVATE DRIVE (11) - between Plots 150 and 151
- SHARED PRIVATE DRIVE (12) - between Plots 152 and 153
- SHARED PRIVATE DRIVE (13) - between Plots 154 and 155
- SHARED PRIVATE DRIVE (14) - between Plots 156 and 157
- SHARED PRIVATE DRIVE (15) - between Plots 158 and 159
- SHARED PRIVATE DRIVE (16) - between Plots 160 and 161
- SHARED PRIVATE DRIVE (17) - between Plots 162 and 163
- SHARED PRIVATE DRIVE (18) - between Plots 164 and 165
- SHARED PRIVATE DRIVE (19) - between Plots 166 and 167
- SHARED PRIVATE DRIVE (20) - between Plots 168 and 169
- SHARED PRIVATE DRIVE (21) - between Plots 170 and 171
- SHARED PRIVATE DRIVE (22) - between Plots 172 and 173
- SHARED PRIVATE DRIVE (23) - between Plots 174 and 175
- SHARED PRIVATE DRIVE (24) - between Plots 176 and 177
- SHARED PRIVATE DRIVE (25) - between Plots 178 and 179
- SHARED PRIVATE DRIVE (26) - between Plots 180 and 181
- SHARED PRIVATE DRIVE (27) - between Plots 182 and 183
- SHARED PRIVATE DRIVE (28) - between Plots 184 and 185
- SHARED PRIVATE DRIVE (29) - between Plots 186 and 187
- SHARED PRIVATE DRIVE (30) - between Plots 188 and 189
- SHARED PRIVATE DRIVE (31) - between Plots 190 and 191
- SHARED PRIVATE DRIVE (32) - between Plots 192 and 193
- SHARED PRIVATE DRIVE (33) - between Plots 194 and 195
- SHARED PRIVATE DRIVE (34) - between Plots 196 and 197
- SHARED PRIVATE DRIVE (35) - between Plots 198 and 199
- SHARED PRIVATE DRIVE (36) - between Plots 200 and 201
- SHARED PRIVATE DRIVE (37) - between Plots 202 and 203
- SHARED PRIVATE DRIVE (38) - between Plots 204 and 205
- SHARED PRIVATE DRIVE (39) - between Plots 206 and 207
- SHARED PRIVATE DRIVE (40) - between Plots 208 and 209
- SHARED PRIVATE DRIVE (41) - between Plots 210 and 211
- SHARED PRIVATE DRIVE (42) - between Plots 212 and 213
- SHARED PRIVATE DRIVE (43) - between Plots 214 and 215
- SHARED PRIVATE DRIVE (44) - between Plots 216 and 217
- SHARED PRIVATE DRIVE (45) - between Plots 218 and 219
- SHARED PRIVATE DRIVE (46) - between Plots 220 and 221
- SHARED PRIVATE DRIVE (47) - between Plots 222 and 223
- SHARED PRIVATE DRIVE (48) - between Plots 224 and 225
- SHARED PRIVATE DRIVE (49) - between Plots 226 and 227
- SHARED PRIVATE DRIVE (50) - between Plots 228 and 229
- SHARED PRIVATE DRIVE (51) - between Plots 230 and 231
- SHARED PRIVATE DRIVE (52) - between Plots 232 and 233
- SHARED PRIVATE DRIVE (53) - between Plots 234 and 235
- SHARED PRIVATE DRIVE (54) - between Plots 236 and 237
- SHARED PRIVATE DRIVE (55) - between Plots 238 and 239
- SHARED PRIVATE DRIVE (56) - between Plots 240 and 241
- SHARED PRIVATE DRIVE (57) - between Plots 242 and 243
- SHARED PRIVATE DRIVE (58) - between Plots 244 and 245
- SHARED PRIVATE DRIVE (59) - between Plots 246 and 247
- SHARED PRIVATE DRIVE (60) - between Plots 248 and 249
- SHARED PRIVATE DRIVE (61) - between Plots 250 and 251
- SHARED PRIVATE DRIVE (62) - between Plots 252 and 253
- SHARED PRIVATE DRIVE (63) - between Plots 254 and 255
- SHARED PRIVATE DRIVE (64) - between Plots 256 and 257
- SHARED PRIVATE DRIVE (65) - between Plots 258 and 259
- SHARED PRIVATE DRIVE (66) - between Plots 260 and 261
- SHARED PRIVATE DRIVE (67) - between Plots 262 and 263
- SHARED PRIVATE DRIVE (68) - between Plots 264 and 265
- SHARED PRIVATE DRIVE (69) - between Plots 266 and 267
- SHARED PRIVATE DRIVE (70) - between Plots 268 and 269
- SHARED PRIVATE DRIVE (71) - between Plots 270 and 271
- SHARED PRIVATE DRIVE (72) - between Plots 272 and 273
- SHARED PRIVATE DRIVE (73) - between Plots 274 and 275
- SHARED PRIVATE DRIVE (74) - between Plots 276 and 277
- SHARED PRIVATE DRIVE (75) - between Plots 278 and 279
- SHARED PRIVATE DRIVE (76) - between Plots 280 and 281
- SHARED PRIVATE DRIVE (77) - between Plots 282 and 283
- SHARED PRIVATE DRIVE (78) - between Plots 284 and 285

- EXTERNAL REFUSE STORE (1) - between Plots 168-179, 180,181,183,185
- EXTERNAL REFUSE STORE (2) - between Plots 182,184,186 through 198
- EXTERNAL REFUSE STORE (3) - between Plots 276 through 285
- EXTERNAL REFUSE STORE (4) - between Plots 268 through 275
- EXTERNAL REFUSE STORE (5) - between Plots 253 through 261
- EXTERNAL REFUSE STORE (6) - between Plots 1 through 10
- INTERNAL REFUSE STORE (1) - between Plots 199 through 213
- INTERNAL REFUSE STORE (2) - between 214 through 232
- INTERNAL REFUSE STORE (3) - between 233 through 252
- INTERNAL REFUSE STORE (4) - between 233 through 252
- INTERNAL BIKE STORE (1) - between Plots 168 through 198
- INTERNAL BIKE STORE (2) - between Plots 199 through 213
- INTERNAL BIKE STORE (3) - between Plots 214 through 232
- INTERNAL BIKE STORE (4) - between Plots 233 through 252

Key

- Overall Site Boundary
- Shared Common Areas Within Flatted Blocks
- Shared Private Driveways (see ownership schedule)
- Shared Private Courtyards (see ownership schedule)



Cairnlee House, Callendar Business Park
 Callendar Road, Falkirk, FK1 1XE,
 Tel 01324 600000 Fax 01324 600001
 www.cala.co.uk

JOB TITLE
Edinburgh, West Criags

DRAWING TITLE
**DPA Site Plan
 Ground Level**

The development registered under title MID234914 and plots 001 to 134, 136 to 139, 143 to 146, 148 to 156, 165 to 179 and 181 to 285 within have been DPA approved on behalf of:

The Keeper - 29 November 2024

Keeper of the Registers of Scotland

SCALE:1:1000 SHEET SIZE:A1 DATE: Jul 23

DRAWN BY: DM	PRELIMINARY	FINAL
CHECKED BY: CENTRAL MASTERED	DEVELOPMENT MASTERED	
SITE: EA00213	MCCOSKER	VER MOD DRG No. REV PLOT
		DPA(00) D.1

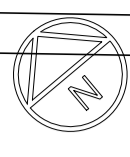

Meadowfield Farm Cottages

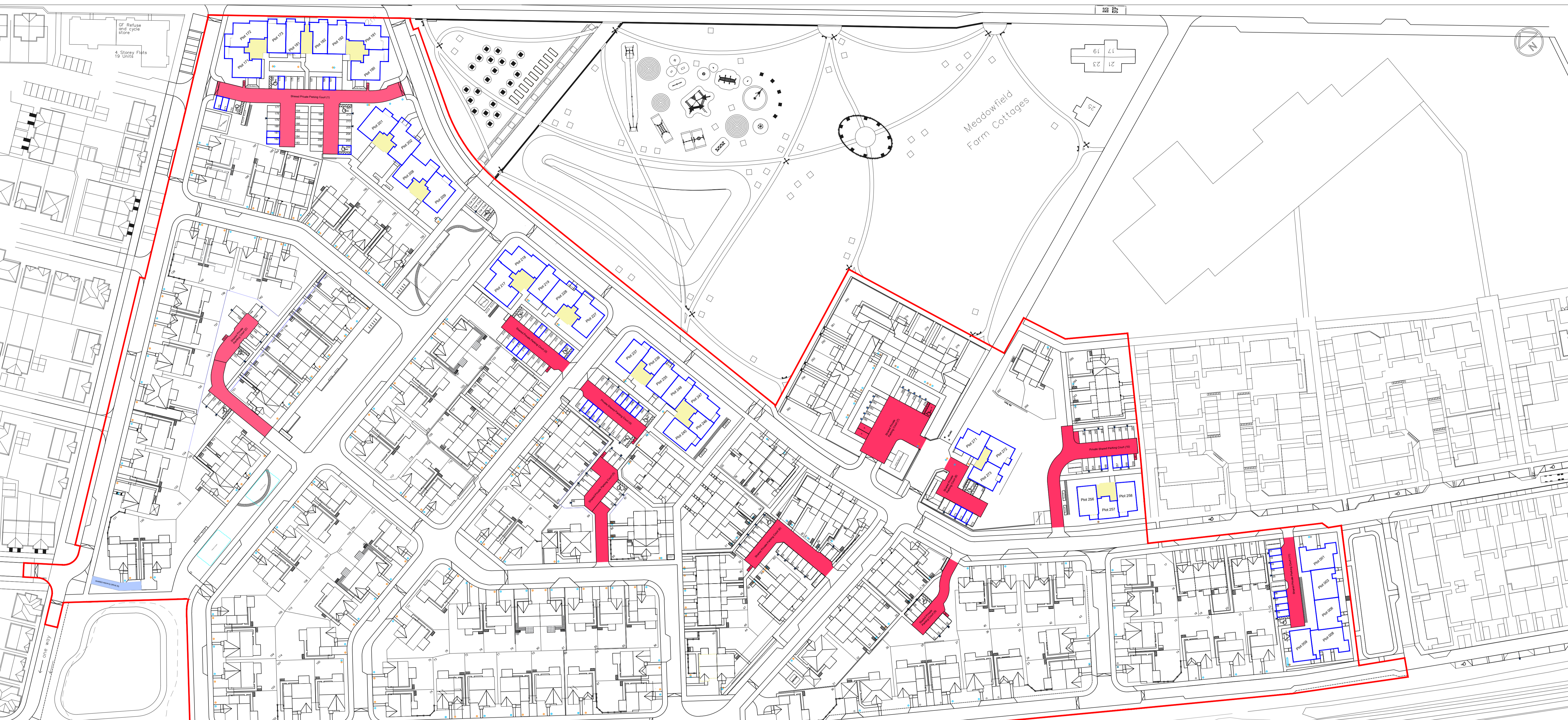

OWNERSHIP SCHEDULE

SHARED PRIVATE DRIVE (1) - between Plots 130 and 131

SHARED PRIVATE COURTYARD (1) - between Plots 168 through 213

SHARED PRIVATE COURTYARD (2) - between Plots 143 through 155

SHARED PRIVATE COURTYARD (3) - between Plots 214 through 232

SHARED PRIVATE COURTYARD (4) - between Plots 233 through 251

SHARED PRIVATE COURTYARD (5) - between Plots 85 through 96

SHARED PRIVATE COURTYARD (6) - between Plots 51 through 66

SHARED PRIVATE COURTYARD (7) - between Plots 276 through 285

SHARED PRIVATE COURTYARD (8) - between Plots 269 through 275

SHARED PRIVATE COURTYARD (9) - between Plots 32 through 39

SHARED PRIVATE COURTYARD (10) - between Plots 253 through 267

SHARED PRIVATE COURTYARD (11) - between Plots 1 through 10

EXTERNAL REFUSE STORE (1) - between Plots 168-179, 180,181,183,185

EXTERNAL REFUSE STORE (2) - between Plots 182,184,186 through 198

EXTERNAL REFUSE STORE (3) - between Plots 276 through 285

EXTERNAL REFUSE STORE (4) - between Plots 268 through 275

EXTERNAL REFUSE STORE (5) - between Plots 253 through 261

EXTERNAL REFUSE STORE (6) - between Plots 1 through 10

INTERNAL REFUSE STORE (1) - between Plots 199 through 213

INTERNAL REFUSE STORE (2) - between 214 through 232

INTERNAL REFUSE STORE (3) - between 233 through 252

INTERNAL REFUSE STORE (4) - between 233 through 252

INTERNAL BIKE STORE (1) - between Plots 168 through 198

INTERNAL BIKE STORE (2) - between Plots 199 through 213

INTERNAL BIKE STORE (3) - between Plots 214 through 232

INTERNAL BIKE STORE (4) - between Plots 233 through 252

Key

- Overall Site Boundary
- Shared Common Areas Within Flatted Blocks
- Shared Private Driveways (see ownership schedule)
- Shared Private Courtyards (see ownership schedule)



Cairnlee House, Callendar Business Park
 Callendar Road, Falkirk, FK1 1XE,
 Tel 01324 600000 Fax 01324 600001
 www.cala.co.uk

JOB TITLE
Edinburgh, West Criags

DRAWING TITLE
**DPA Site Plan
 1st Floor Level**

SCALE:1:1000 SHEET SIZE:A1 DATE: Jul 23

DRAWN BY: DM	PRELIMINARY	FINAL				
CHECKED BY:	CENTRAL MASTERED	DEVELOPMENT MASTERED				
SITE	McCOSKER	VER	MOD	DRG No.	REV	PLOT
EA00213				DPA(01)	D.1	

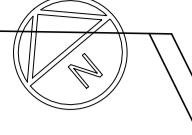
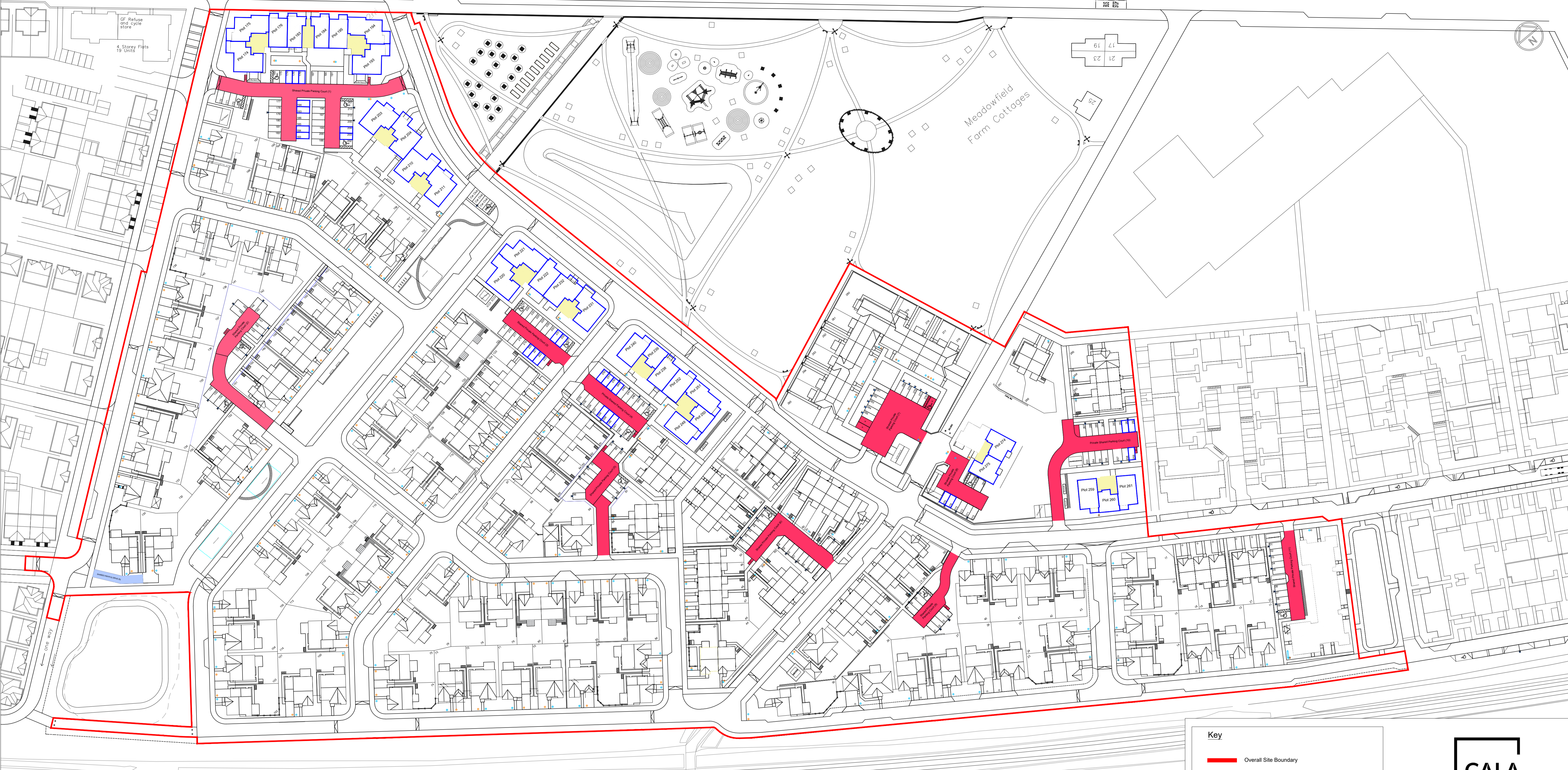

OWNERSHIP SCHEDULE

SHARED PRIVATE DRIVE (1) - between Plots 130 and 131	EXTERNAL REFUSE STORE (1) - between Plots 168-179, 180,181,183,185
SHARED PRIVATE DRIVE (2) - between Plots 143 through 155	EXTERNAL REFUSE STORE (2) - between Plots 182,184,186 through 198
SHARED PRIVATE DRIVE (3) - between Plots 214 through 232	EXTERNAL REFUSE STORE (3) - between Plots 276 through 285
SHARED PRIVATE DRIVE (4) - between Plots 233 through 251	EXTERNAL REFUSE STORE (4) - between Plots 268 through 275
SHARED PRIVATE DRIVE (5) - between Plots 85 through 96	EXTERNAL REFUSE STORE (5) - between Plots 253 through 261
SHARED PRIVATE DRIVE (6) - between Plots 51 through 66	EXTERNAL REFUSE STORE (6) - between Plots 1 through 10
SHARED PRIVATE DRIVE (7) - between Plots 276 through 285	INTERNAL REFUSE STORE (1) - between Plots 199 through 213
SHARED PRIVATE DRIVE (8) - between Plots 269 through 275	INTERNAL REFUSE STORE (2) - between 214 through 232
SHARED PRIVATE DRIVE (9) - between Plots 32 though 39	INTERNAL REFUSE STORE (3) - between 233 through 252
SHARED PRIVATE DRIVE (10) - between Plots 253 though 267	INTERNAL REFUSE STORE (4) - between 233 through 252
SHARED PRIVATE DRIVE (11) - between Plots 1 though 10	INTERNAL BIKE STORE (1) - between Plots 168 through 198
	INTERNAL BIKE STORE (2) - between Plots 199 through 213
	INTERNAL BIKE STORE (3) - between Plots 214 through 232
	INTERNAL BIKE STORE (4) - between Plots 233 through 252

Key

- Overall Site Boundary
- Shared Common Areas Within Flatted Blocks
- Shared Private Driveways (see ownership schedule)
- Shared Private Courtyards (see ownership schedule)



Cairnlee House, Callendar Business Park
 Callendar Road, Falkirk, FK1 1XE,
 Tel 01324 600000 Fax 01324 600001
 www.cala.co.uk

JOB TITLE
Edinburgh, West Criags

DRAWING TITLE
**DPA Site Plan
 2nd Floor Level**

SCALE: 1:1000 SHEET SIZE: A1 DATE: Jul 23

DRAWN BY: DM	PRELIMINARY	FINAL
CHECKED BY:	CENTRAL MASTERED	DEVELOPMENT MASTERED
SITE	MECOSKER	VER
EA00213	MOD	DRG No. DPA(02)
	REV	PLOT D.1

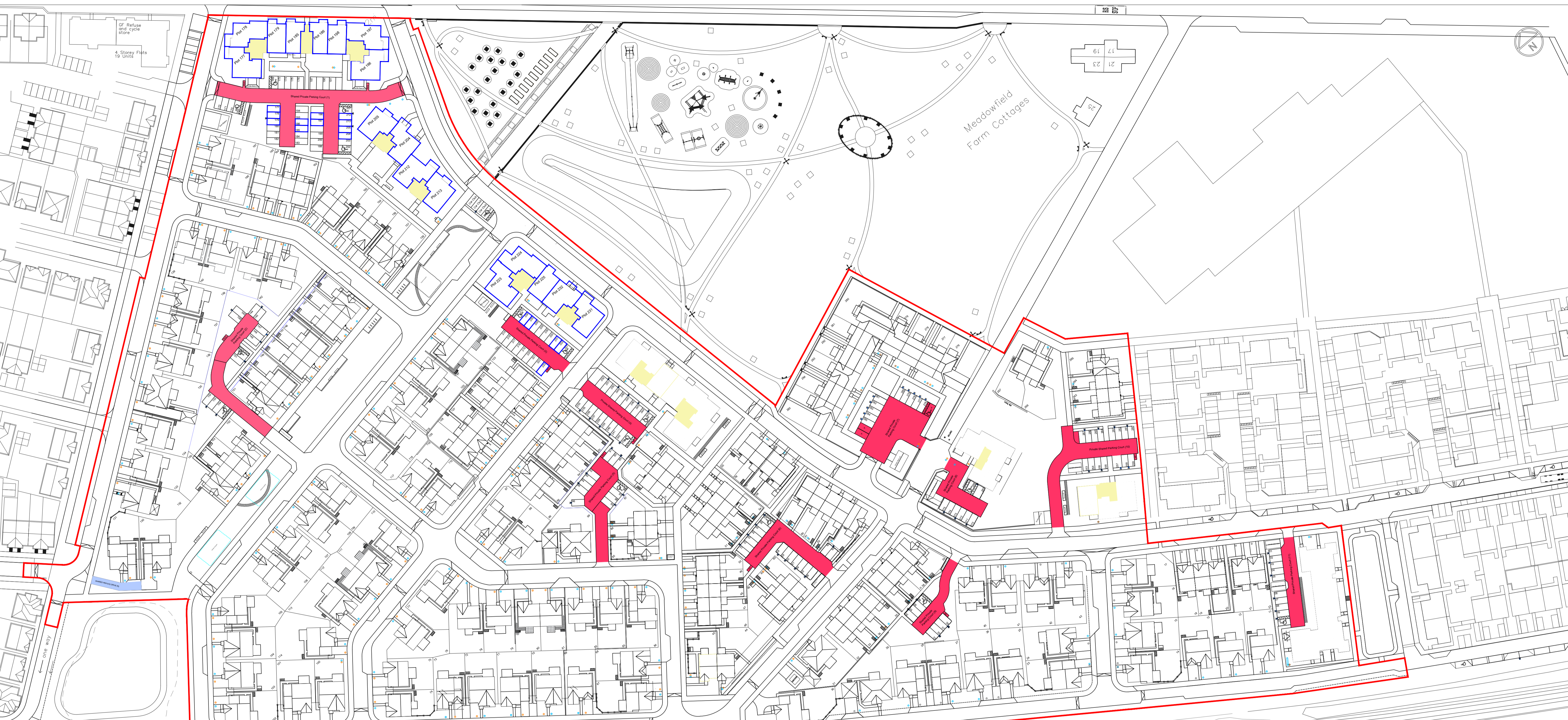
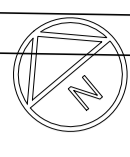

Key

- Overall Site Boundary
- Shared Common Areas Within Flatted Blocks
- Shared Private Driveways (see ownership schedule)
- Shared Private Courtyards (see ownership schedule)



Cairnlee House, Callendar Business Park
Callendar Road, Falkirk, FK1 1XE,
Tel 01324 600000 Fax 01324 600001
www.cala.co.uk

JOB TITLE
Edinburgh, West Criags

DRAWING TITLE
**DPA Site Plan
3rd Floor Level**

SCALE: 1:1000 SHEET SIZE: A1 DATE: Jul 23

DRAWN BY: DM	PRELIMINARY	FINAL
CHECKED BY:	CENTRAL MASTERED	DEVELOPMENT MASTERED

SITE	McCOSKER	VER	MOD	DRG No.	REV	PLOT
EA00213				DPA(03)	D.1	

OWNERSHIP SCHEDULE

SHARED PRIVATE DRIVE (1) - between Plots 130 and 131

SHARED PRIVATE COURTYARD (1) - between Plots 168 through 213

SHARED PRIVATE COURTYARD (2) - between Plots 143 through 155

SHARED PRIVATE COURTYARD (3) - between Plots 214 through 232

SHARED PRIVATE COURTYARD (4) - between Plots 233 through 251

SHARED PRIVATE COURTYARD (5) - between Plots 85 through 96

SHARED PRIVATE COURTYARD (6) - between Plots 51 through 66

SHARED PRIVATE COURTYARD (7) - between Plots 276 through 285

SHARED PRIVATE COURTYARD (8) - between Plots 269 through 275

SHARED PRIVATE COURTYARD (9) - between Plots 32 through 39

SHARED PRIVATE COURTYARD (10) - between Plots 253 through 267

SHARED PRIVATE COURTYARD (11) - between Plots 1 through 10

EXTERNAL REFUSE STORE (1) - between Plots 168-179, 180,181,183,185

EXTERNAL REFUSE STORE (2) - between Plots 182,184,186 through 198

EXTERNAL REFUSE STORE (3) - between Plots 276 through 285

EXTERNAL REFUSE STORE (4) - between Plots 268 through 275

EXTERNAL REFUSE STORE (5) - between Plots 253 through 261

EXTERNAL REFUSE STORE (6) - between Plots 1 through 10

INTERNAL REFUSE STORE (1) - between Plots 199 through 213

INTERNAL REFUSE STORE (2) - between 214 through 232

INTERNAL REFUSE STORE (3) - between 233 through 252

INTERNAL REFUSE STORE (4) - between 233 through 252

INTERNAL BIKE STORE (1) - between Plots 168 through 198

INTERNAL BIKE STORE (2) - between Plots 199 through 213

INTERNAL BIKE STORE (3) - between Plots 214 through 232

INTERNAL BIKE STORE (4) - between Plots 233 through 252