

- DEVELOPMENT BOUNDARY
- PLOT BOUNDARY
- Public Open Space
- ADOPTABLE CARRIAGEWAY, FOOTPATHS & VERGES
- NON-ADOPTED PARKING COURT FLATTED BLOCKS 1-3
- NON-ADOPTED PARKING COURT FLATTED BLOCKS 4 & 5
- NON-ADOPTED PARKING COURT PLOTS 28-31
- BS B- COMMUNAL BIN STORE FLATTED BLOCKS 1-5
- AP B- ACCESS PATH FLATTED BLOCKS 1-5
- ST B- SPRINKLER TANK & PUMP HOUSING FLATTED BLOCKS 1-5
- SHARED REAR ACCESS PATH PLOTS 8 & 9
- SHARED REAR ACCESS PATH PLOTS 13 & 14
- SHARED REAR ACCESS PATH PLOTS 18 & 19
- SHARED REAR ACCESS PATH PLOTS 29 & 30
- SHARED DRIVEWAY PLOTS 36 & 37
- SPEN SUBSTATION
- SCOTTISH WATER PUMPING STATION & PARKING BAY
- vp VISITOR PARKING SPACE
- EVCvp VISITOR PARKING SPACE WITH ELECTRIC VEHICLE CHARGING POINT

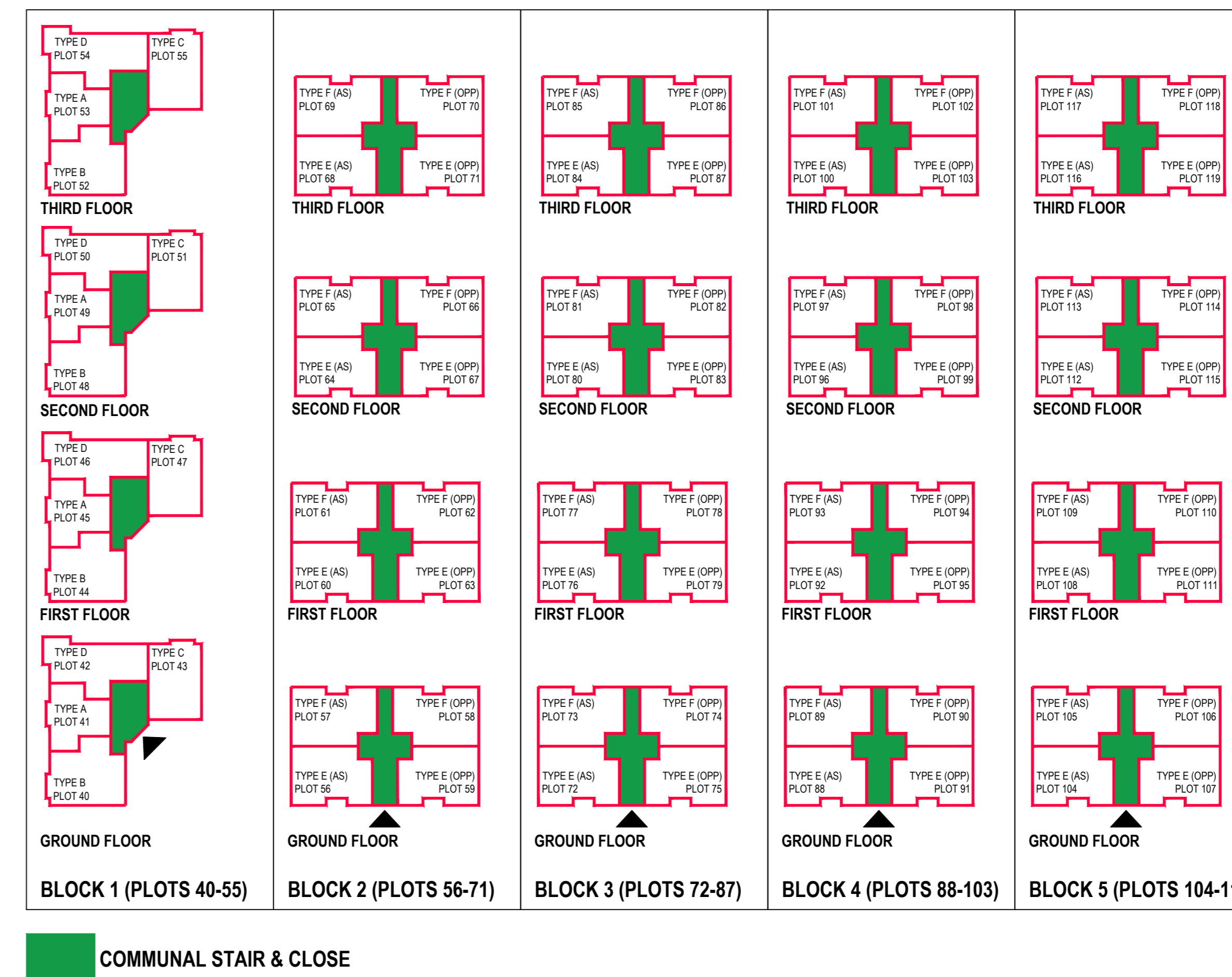

The Development registered under title REN118915 and plots 1, 3, 6 to 23, 25, 32, 34 to 119 and 300 to 302 within have been DPA approved.

*The Keeper - 13 January 2025*

Keeper for the Registers of Scotland

AMENDMENTS

Issue	Date	Detail
E	24.06.24	Block 2 repositioned; adjacent parking bays, footpaths and bin store arrangement amended to suit. Block 1's sprinkler tank and binstore positions swapped. Block 4's sprinkler tank repositioned.
D	16.02.24	Block 4 & 5 parking court - visitor parking spaces with EV charging point relocated
C	22.01.24	REMIK: Plot 12-16 and 300-302 boundaries amended. Plot 13 & 14 shared rear access path added to legend.
B	09.01.24	Flatted Blocks 1 & 3 moved to avoid existing services. Block 3's binstore and Block 2's sprinkler tank repositioned to suit. Section of footpath removed between parking bays 73 & 74, parking court length reduced accordingly.
A	18.10.23	Adoptable carriageway, footpaths and verges coloured



Project  
**FERRY GROVE  
 RENFREW**

Drawing  
**DEVELOPMENT PLAN  
 APPROVAL**

Scale	Drawn By	Date
1:500@A0	MB	18.08.23
Drawing No		
LAY-DPA-01	E	