

NOTES

NOTICE TO HOUSE PURCHASERS
Project Memorandum Act 2001
Buyers are advised that this is a working drawing & is not intended to be treated as descriptive material describing or relating to any particular property or development, any of the specified matters prescribed by any order made under the above Act.
The contents of this drawing are subject to change at any time & alterations & variations can occur during the progress of the works without revision of the drawing. Consequently the layout, form, content & dimensions of the finished construction may differ materially from those shown.
Nor do the contents of this drawing constitute a contract, part of any contract or warranty.

LEGEND:

- Development Boundary
- Adoptable Footpaths
- Adoptable Roads
- Factored Public Open Space
- Feu Boundary
- Shared Private Footpath
- Shared Private Driveway
- Factor Maintained Parking Court
- Sprinkler Pumping Station
- Factored Maintained Footpath
- Adoptable Street Lighting Column
- Communal Electric Vehicle Charge Point
Twin PAX 10A Mode 3 Charger
- EVG Feeder Pillar
- Refuse Collection Area
- Drainage Wayleave
- Private Car Parking Space
- Sprinkler Servitude

Plots with shared footpaths:
4-6, 8-9, 24-26, 30-32, 55-57, 58-61, 62-64, 67-69, 70-73, 74-77, 84-85, 117-118, 119-120, 183-184

Plots with shared access/drives:
4-6, 13-15, 23-25, 39-40, 74-78, 97-98, 102-103, 114-116, 172-174, 181-184

Development layout only - may be subject to change
Houses with window or door openings in walls facing boundaries must not be less than 1.5m from the boundary
Each house to be provided with a 600x600mm (min) P.C. slab as a bin stance, adjacent to the rear entrance door
All spoil and vegetable matter (including wood) to be removed over the area of each house and the ground immediately adjoining the house.
All driveways in back to be to Engineers Details
Suitable arisings from excavations provide useful engineering material for raising levels and in forming and contouring areas of landscaping
Accordingly the finished surface levels on this development have been designed to incorporate the benefit of this material, either derived on this site, or on other

PLEASE REFER TO LANDSCAPE CONSULTANT DRAWINGS FOR ALL LANDSCAPE INFORMATION
PLEASE REFER TO ENGINEERING DRAWINGS FOR ALL LEVELS & RETENTION INFORMATION

REV	DATE	DRN	DESCRIPTION
M	Jan 25	AD	Boundary of plots 186 and 187 amended. Plot 115 handing revised. Plots 115 and 116 shared private driveway extended. Plot 116 ownership boundary amended. EV feed pillars relocated. Plot 172 parking amended. Plot 172 and 173 boundaries updated. Plot 172-174 private driveway extended. Plot 8 and 9 shared footpath amended.
L	Sep 24	AD	Boundary of plots 8, 9 and 10 amended.
K	Jul 24	AD	Plot 79 boundary amended. Plot 58 boundary with plots 49, 50, and 51 amended. Plot 189 garden path added. Plot 11 handing changed. Plot 75-78 parking court spaces amended.
J	May 24	AH	Boundary updated to plots 134, 170, 171, 172 & 182 plots 38 to 48 boundaries updated.
G	Nov 23	AH	Missing visitor EV reinstated
F	Oct 23	AH	Revisions made as per Legal comments, sprinkler network added
E	Oct 23	JH	Revisions made as per Legal comments
D	Aug 23	JH	Revisions made as per Legal comments
C	July 23	AH	Revisions made as per Legal comments
B	May 23	JH	Revisions made as per Legal comments
A	Mar 23	JH	Revisions made as per Legal comments issued 25.01.23

Taylor Wimpey East Scotland
1 Macdonald Park
Carnegie Campus
Dunfermline KY11 8PL
Tel 01383 840 700 Fax 01383 845 725
www.taylorwimpey.com



Project:
**Seton Rise
Winchburgh CC & FF**
Title:
Master Feu Layout

22487 / Feu / 01 M
Scale: 1:500 Date: Date
Drawn By: JH Checked By: AH

The Development registered under Title WLN59584
and all plots within including the open spaces have been
DPA approved on behalf of:
The Keeper - 14 January 2025
Keeper for the Registers of Scotland

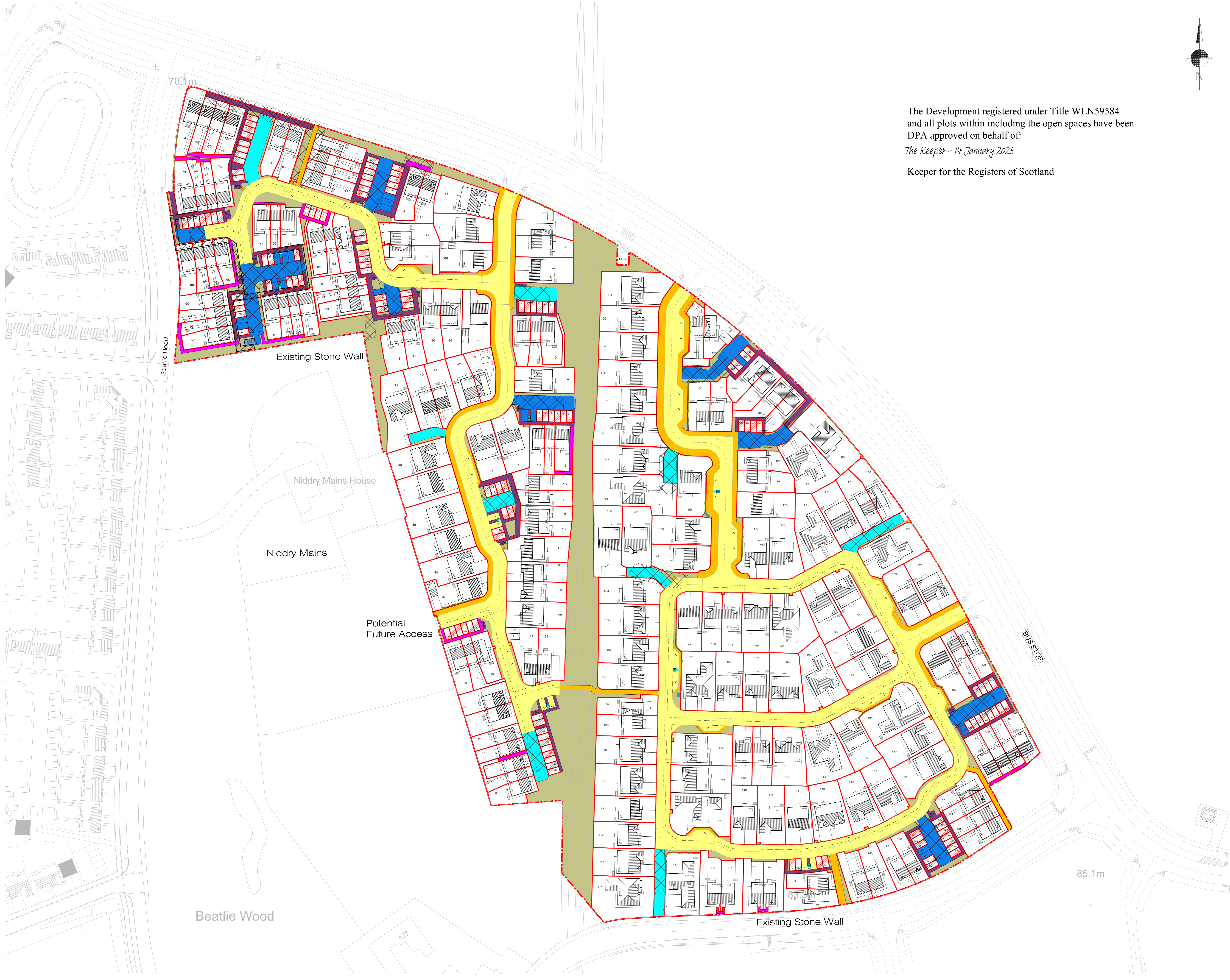

70.1m

85.1m

Beatlie Wood

Existing Stone Wall