

- - - - - DEVELOPMENT BOUNDARY
- PLOT BOUNDARY
- PUBLIC OPEN SPACE
- ADOPTABLE CARRIAGEWAY, FOOTPATHS & VERGES
- NON-ADOPTED PARKING COURT FLATTED BLOCKS 1-3
- NON-ADOPTED PARKING COURT FLATTED BLOCKS 4 & 5
- NON-ADOPTED PARKING COURT PLOTS 28-31
- BS B- COMMUNAL BIN STORE FLATTED BLOCKS 1-5
- AP B- ACCESS PATH FLATTED BLOCKS 1-5
- ST B- SPRINKLER TANK & PUMP HOUSING FLATTED BLOCKS 1-5
- SHARED REAR ACCESS PATH PLOTS 8 & 9
- SHARED REAR ACCESS PATH PLOTS 13 & 14
- SHARED REAR ACCESS PATH PLOTS 18 & 19
- SHARED REAR ACCESS PATH PLOTS 29 & 30
- SHARED DRIVEWAY PLOTS 36 & 37
- SPEN SUBSTATION
- SCOTTISH WATER PUMPING STATION & PARKING BAY

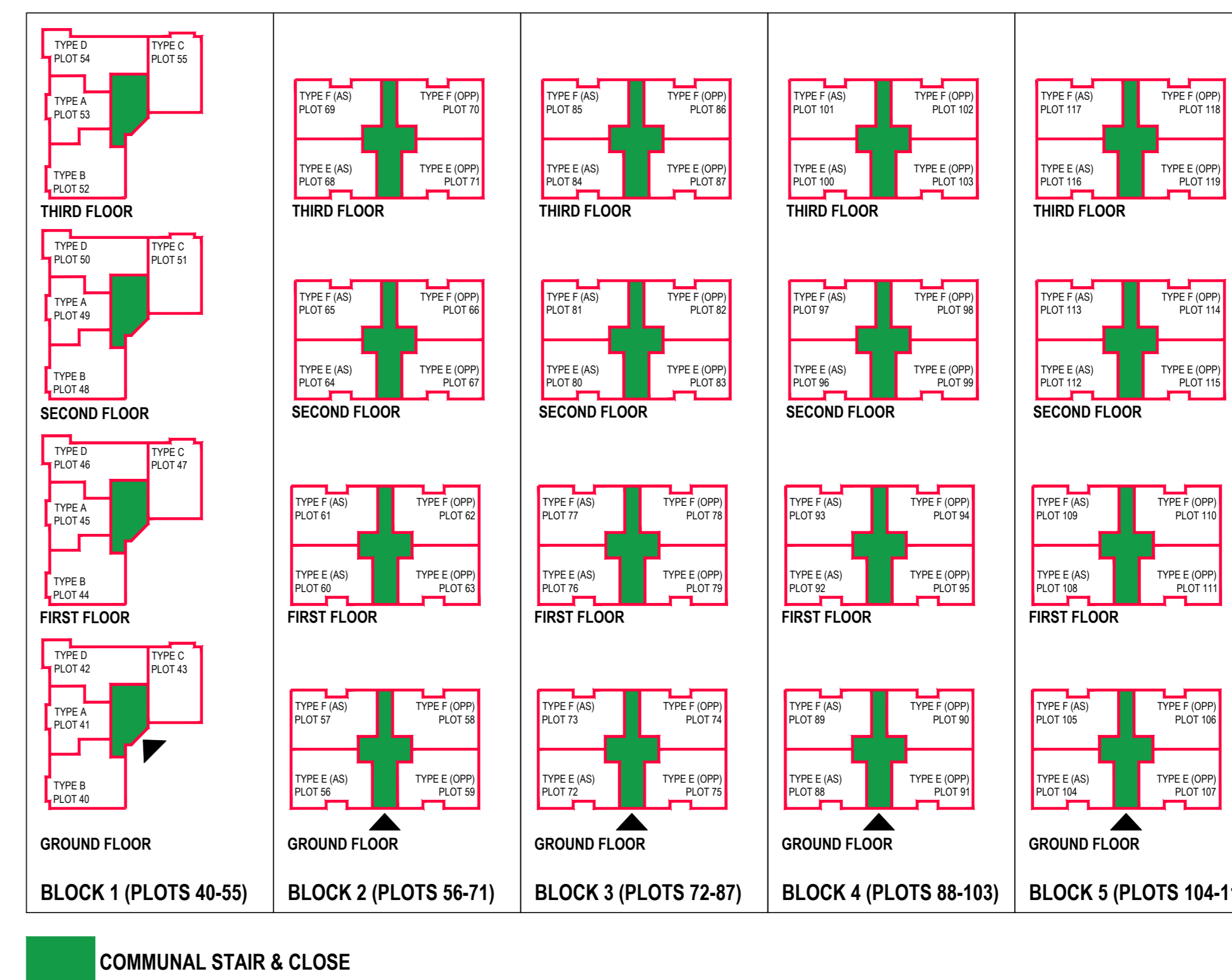

Ordnance Survey, (c) Crown Copyright 2020. All rights reserved. Licence number 100022432

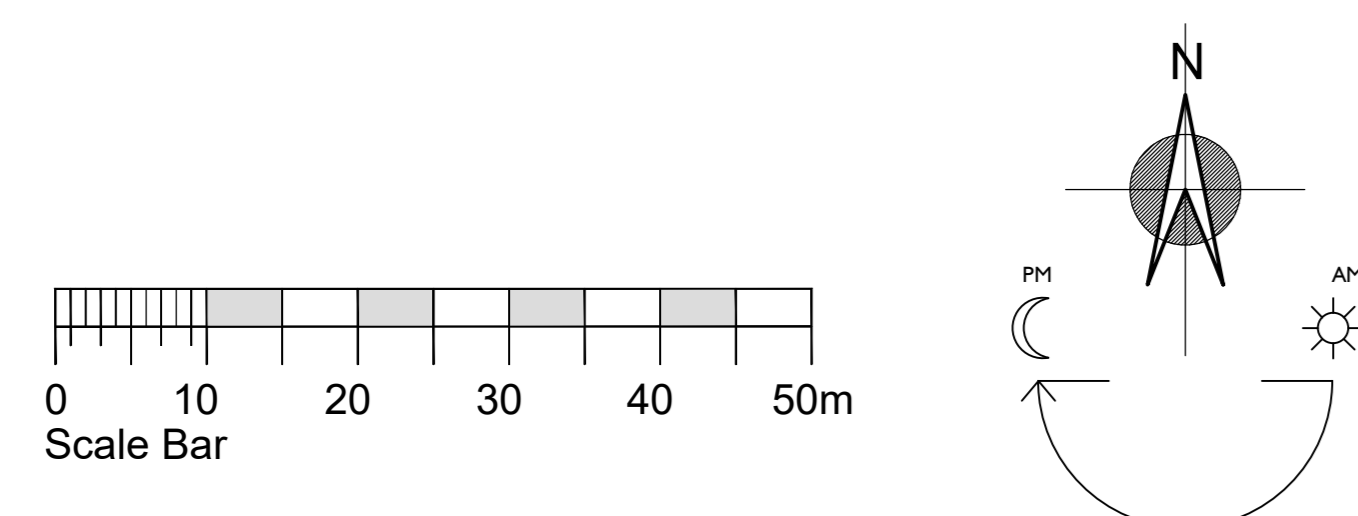

■ COMMUNAL STAIR & CLOSE

The Development registered under title REN118915 and plots 1 to 119 and 300 to 302 within have been DPA approved.

*The Keeper - 08 February 2024*

Keeper for the Registers of Scotland

AMENDMENTS

Issue	Date	Detail
C	22.01.24	REMOX: Plot 12-16 and 300-302 boundaries amended. Plot 13 & 14 shared rear access path added to legend.
B	09.01.24	Flatted Blocks 1 & 3 moved to avoid existing services. Block 3 binstore and Block 2/3 sprinkler tank repositioned to suit. Section of footpath removed between parking bays 73 & 74, parking court length reduced accordingly.
A	18.10.23	Adoptable carriageway, footpaths and verges coloured.



Project  
**FERRY GROVE  
 RENFREW**

Drawing  
**DEVELOPMENT PLAN  
 APPROVAL**

Scale 1:500@A0 Drawn By MB Date 18.08.23

Drawing No LAY-DPA-01	C
--------------------------	---